

製図 2 (CAD) ⑦⑧

投影図のトレース (投影法 P.26~)

図面の種類

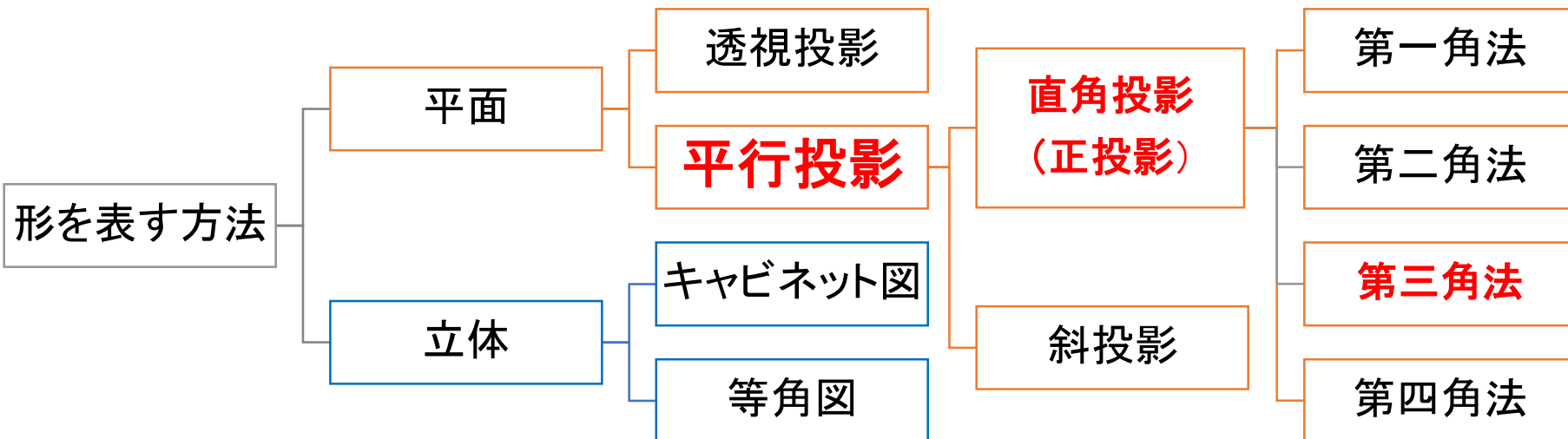

投影図第三角法のポイント

- ① 直接見える形
外形線(太線・実線)で表す
- ② 内側や後ろ側にある形
かくれ線(細線・破線)で表す
- ③ 斜めの面の見え方
奥行が表せないので単純な四角(等)に見える
- ④ 円筒形の見え方
見る向きによっては四角に見える

教科書P.42 課題15⑤

投影図第三角法

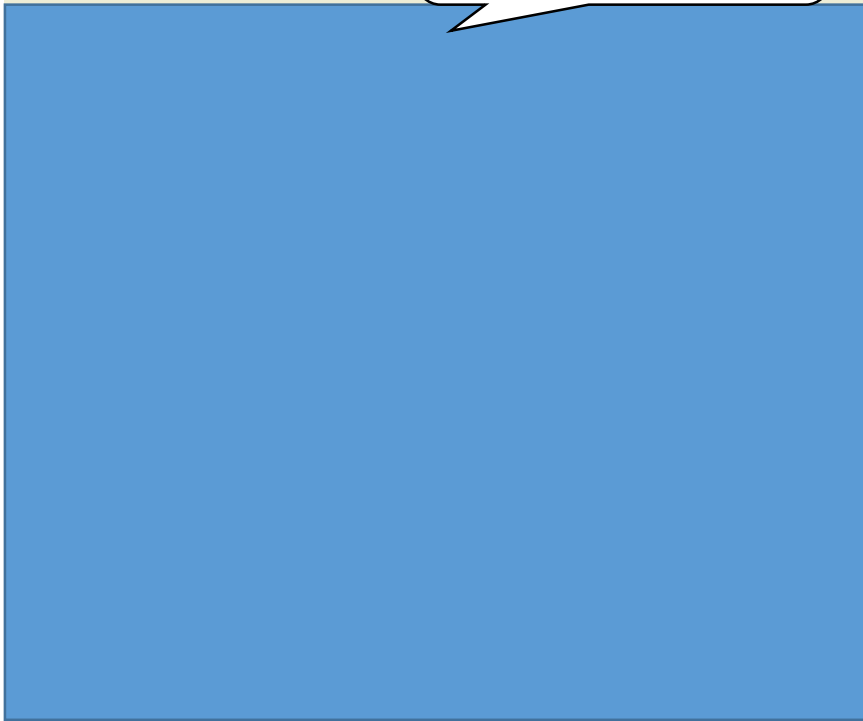

立体図(等角図)

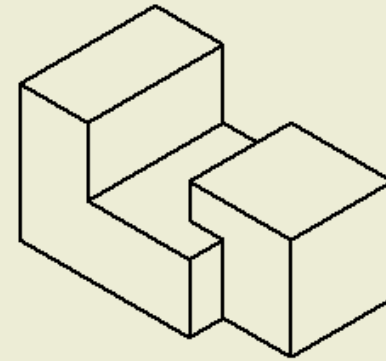

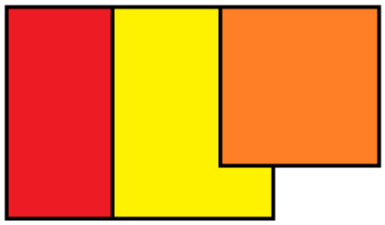

平面図

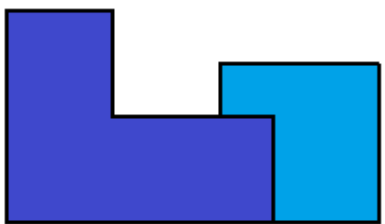
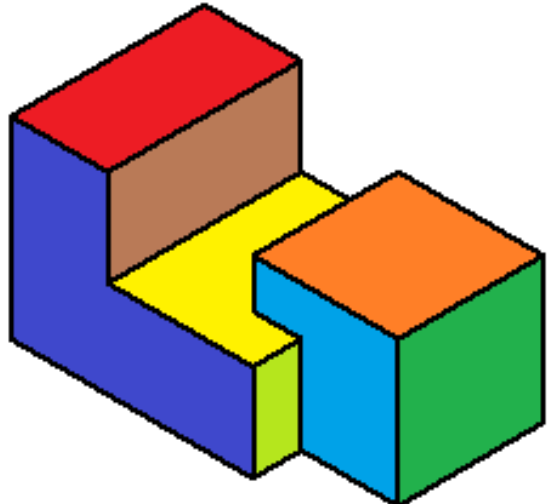

正面図

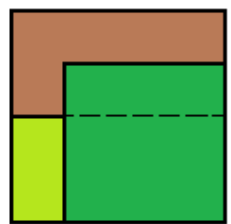

かくれ線
(細線・実線)

右側面図

教科書P.42 課題15①

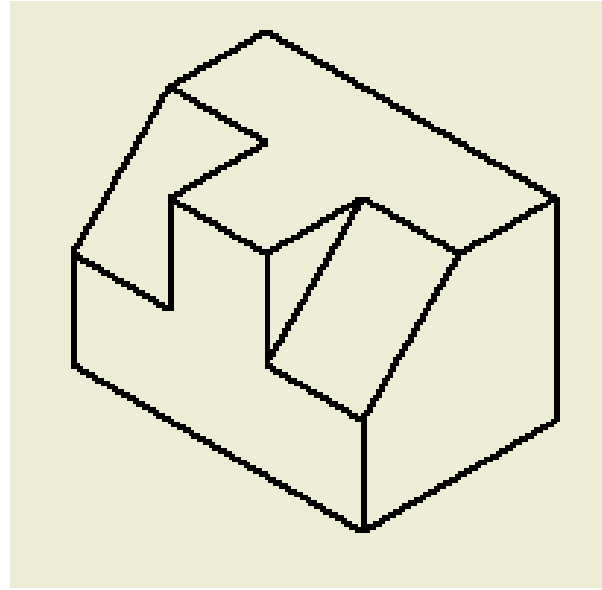
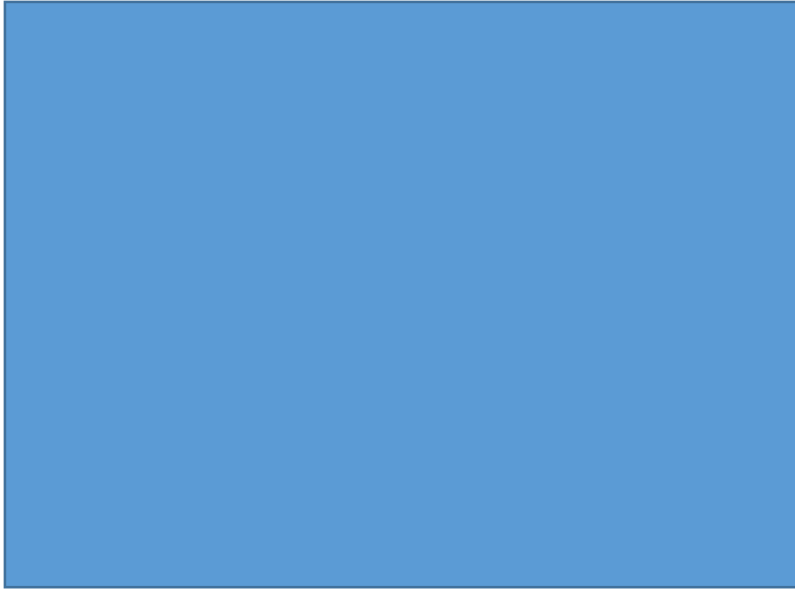

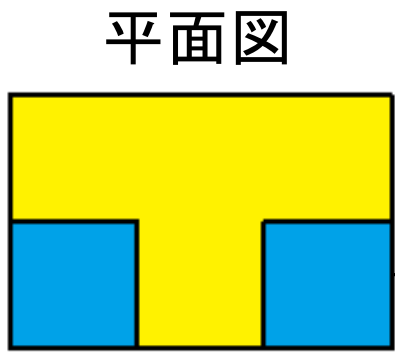

斜面

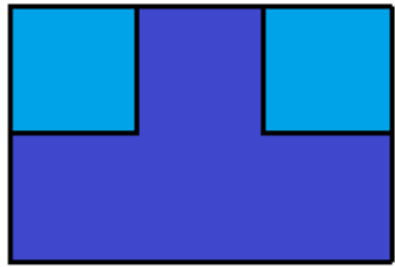

斜面

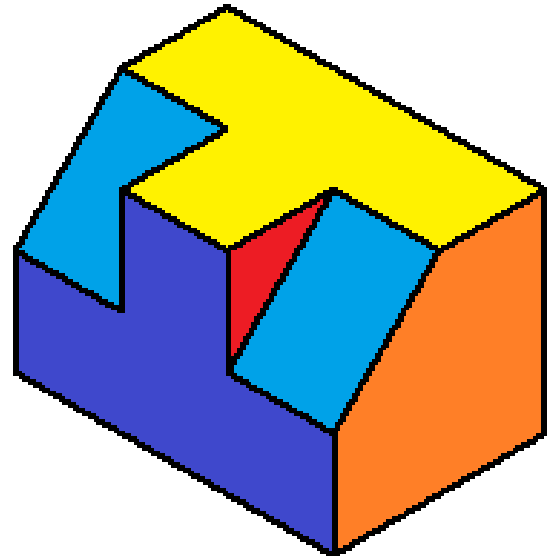

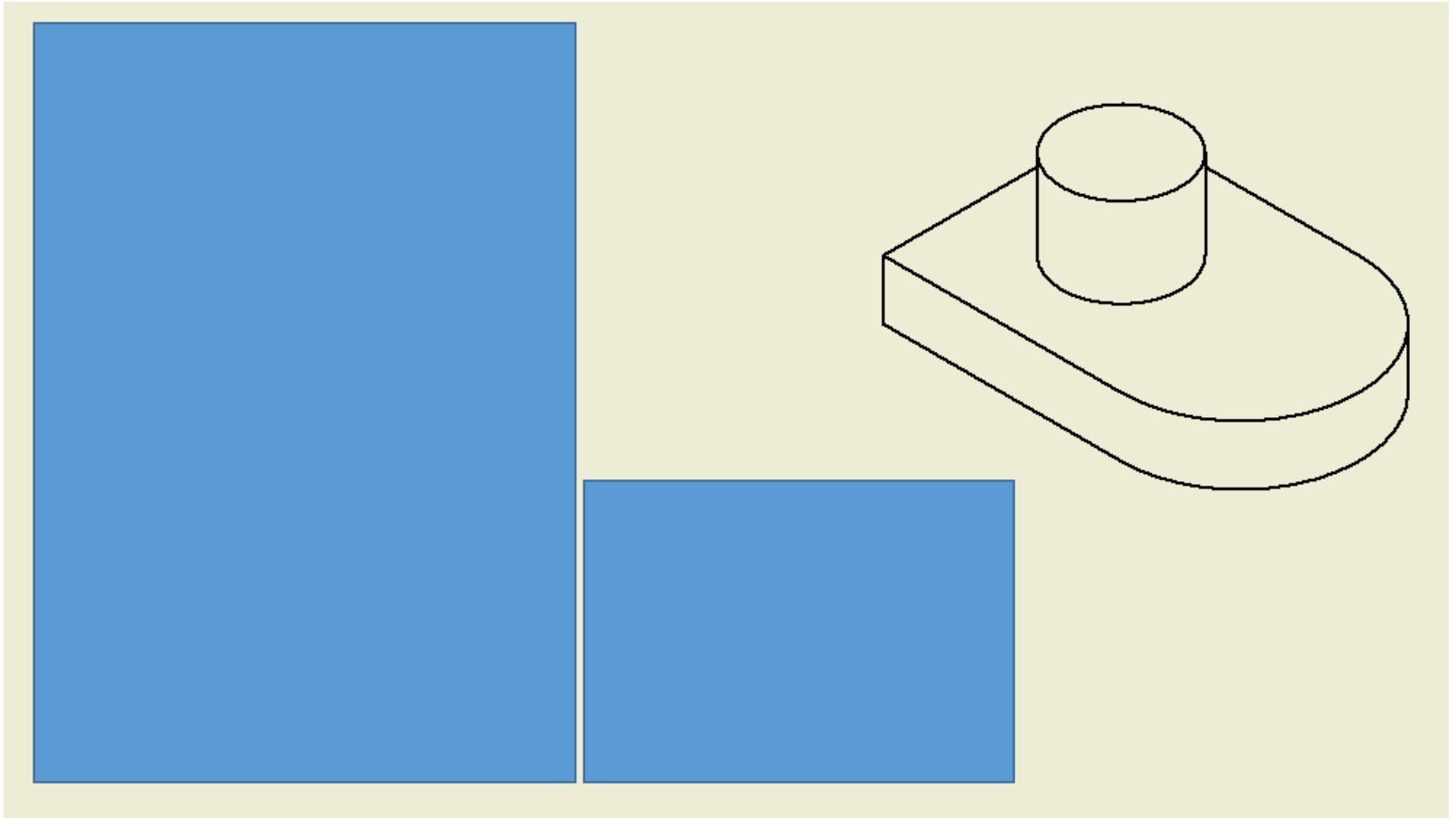

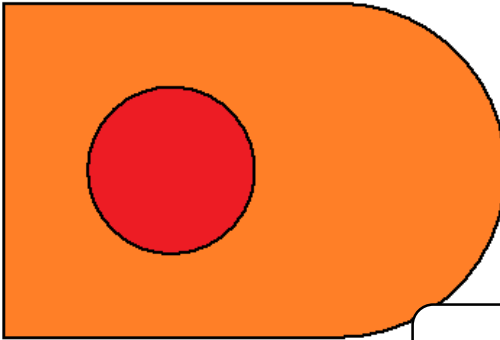

平面図

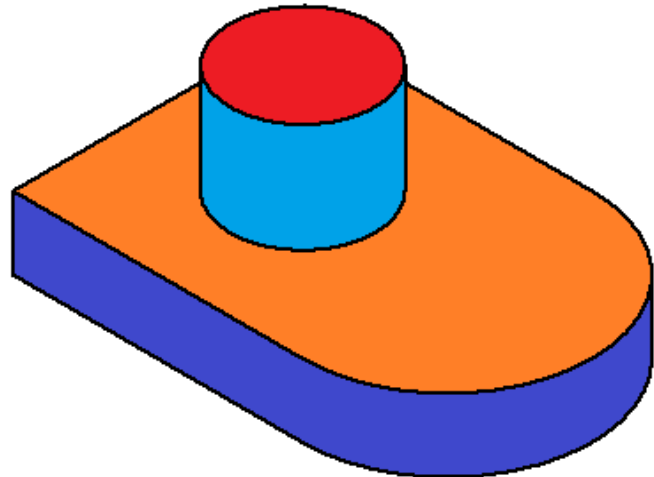

円筒形部位

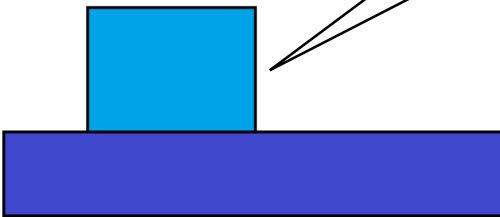

正面図

